

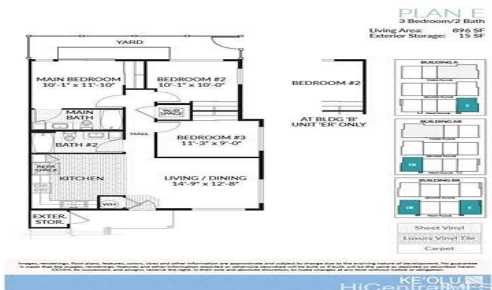

HiCentralMLS



94-1645 Kalanaola Drive #1001

Condo for Sale in **Waipahu**, Oahu | MLS **202524605**

896 sqft living
3 bedrooms
2 bathrooms
\$652,764 listing price

Welcome to Ke'Olu at Koa Ridge. Castle & Cooke's newest affordable townhome community thoughtfully designed for Hawaii families. Nestled in a highly desirable master planned neighborhood in Central Oahu. This 3 bedroom 2 bath townhome with 2 dedicated parking spaces offers spacious open concept living with modern comforts. Enjoy easy access to the H2 freeway and minutes away from Costco, Foodland, local restaurants, Central Oahu Regional Park, Waikale Shopping Center and more. Key features include interior sprinkler system, wall A/C units in living

Listed by **Castle & Cooke Homes Hawaii**



HAWAII LIFE

Statewide Customer Support
Offices on All Islands

HawaiiLife.com

(800) 667-5028 call or text

re@HawaiiLife.com email support